

## 4K 60Hz HDMI2.0 Multi-screen Switcher

Model:CQ4120K

### Features

- Support 4-port HDMI signal input.
- 1-port HDMI2.0 signal input, resolution up to 3840x2160 @60HZ.
- 3-port HDMI1.4 signal input, resolution up to 3840x2160 @30HZ.
- Supported output resolutions: 1920x1080 50Hz, 1920x1080 60Hz, 3840x2160 30Hz, 3840x2160 50Hz, 3840x2160 60Hz.
- RS-232 command can set up to 6 output resolutions.
- RS-232 command can set up to 10 kinds of scene applications.
- Built-in multiple picture modes: 4 split screens/3 split screens/2 split screens/1 large 1 small picture-in-picture/1 large 2 small picture-in-picture/full screen.
- It can be rotated 90 degrees and 180 degrees under the full screen, and can be rotated 180 degrees for each single screen under the 4-split screen.
- In the split display mode, the display position can be changed without plugging or unplugging the signal source.
- Support button switching/ remote control switching/ RS-232 command.
- Support video and audio separation technology, output built-in 3.5mm audio port, can be connected to an additional speaker to output sound.
- Support remote control and command scene storage function, you can quickly use various stored display modes.

### Package contents

- 1 X CQ4120K
- 1 X Remote Control (Battery not provided)
- 1 X DC12V Adapter
- 1 X User Manual

### Diagram

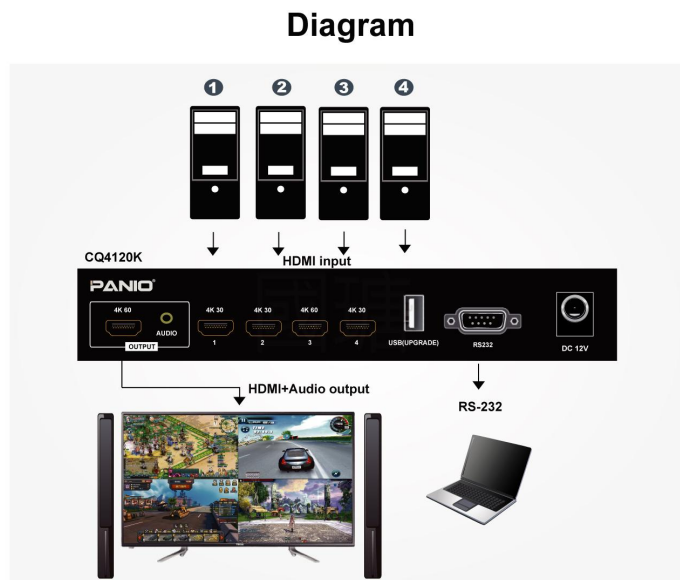

### Specification

<b>Model Name</b>	<b>CQ4120K</b>
Input port	4 x HDMI
Output port	1 x HDMI, 1 x 3.5mm
Supported Resolution	1-channel input supports up to 3840x2160 60HZ, 3-channel input supports up to 3840x2160 30HZ
Output support	3840x2160 60HZ, 3840x2160 30HZ, 1920x1080 60HZ
Presentation Display Mode	4-split screen / 3-split screen / 2-split screen / 1 large 1 small picture-in-picture / 1 large 2 small picture-in-picture / full screen
Switching method	Remote control, button, RS-232 command
Power supply	DC 12V
Weight	800g
Dimensions	223 x 93 x 27mm ( LxWxH )